



DECKS

Along with a completed application permit form, please provide a drawing of the deck, materials to be used, method of construction, and means of attachment to the building or ground.

PERMIT FEE & REVIEW

The Building Inspector usually requires up to seven (7) business days to review a building permit application for a deck, and if approved, deck permits are seventy five dollars (\$75). An additional fifty dollar (\$50) engineering review fee may also apply.

BUILDING PERMIT APPLICATION

Applicants must submit the following items for a deck permit.

1. A Completed Building Permit Application with all contractors listed.
 - A contractor must have a current license before the Village will release a permit.
 - The Village does not require homeowners to have a contractor’s license in order to demolish, rehabilitate, alter or repair their own home or property.
2. An accurate, up-to-date plat of survey depicting the proposed location and size of the improvement.
3. Deck plans (plan view, foundation plan, and elevation views).

AFTER APPROVAL & DURING CONSTRUCTION

Homeowners or contractors should display the permit card onsite and must schedule inspections at least twenty-four (24) hours in advance by calling (630) 671-2821. The Department is open at the following times:

Monday	8:00 am – 5:00 pm
Tuesday	8:00 am – 5:00 pm
Wednesday	8:00 am – 1:00 pm
Thursday	8:00 am – 5:00 pm
Friday	8:00 am – 5:00 pm

Feel free to ask Community Development Department Staff for help by visiting the Department in Village Hall at 31 S. Prospect Street or by calling (630) 671-2821.

** Community Development Department Staff can help determine whether a homeowner can construct an improvement before they apply for a building permit or hire an architect or contractor. Homeowners should bring an accurate, up-to-date plat of survey to the Community Development Department in Village Hall with the improvement(s) depicted to-scale and Staff will provide feedback – this may require a few days.*

Always Call JULIE Before You Dig at 8-1-1 or (800) 892-0123

Along with a completed application permit form, please provide drawings of the deck, materials to be used, method of construction, and means of attaching to the building or ground.

FROST FOOTINGS

Decks attached to a dwelling or a garage must utilize frost footings, which are forty-two inches (42") deep.

GUARDRAILS

All decks that are thirty inches (30") or higher than ground level must contain guardrails that are no less than thirty-six inches (36") in height. Open guardrails and stair railings shall have intermediate rails or an ornamental pattern so that a five-inch (5") diameter sphere cannot pass through any opening.

OVERHANGING DECKS

Joists should not overhang beams by more than two feet (2'), nor should beams overhang posts by more than one-foot (1'). The Building Inspector may approve other designs; however, they must carry the seal of a licensed architect or structural engineer.

LIVE LOADS

A live load is any weight added to the finished structure. The design of all decks must support a live load of forty pounds per square foot (40 pounds/ft²).

FLASHINGS

Any cuts in the exterior finish must be flashed and caulked. All connections between decks and dwellings shall be weatherproofed with materials such as caulk, plastic or flashing.

JOIST HANGERS

Header joists more than six feet (6') long and tail joists more than twelve feet (12') long shall be supported by approved framing anchors such as joist hangers.

REQUIRED WOOD

All exposed wood used in the construction of decks is required to be a wood with a proven natural resistance to decay such as redwood or cedar or a treated wood. This includes posts, beams, joists and decking.

SPECIAL DESIGN NOTE

Some designs may not be appropriate should the placement of a screened porch or three-season porch on the deck platform be a future consideration.

Single Beam Deck Foundation Plan: Example Only

HOUSE

Remove siding before installing Ledger Boards. Provide Continuous Flashing With Drip Edge Over The Ledger Board

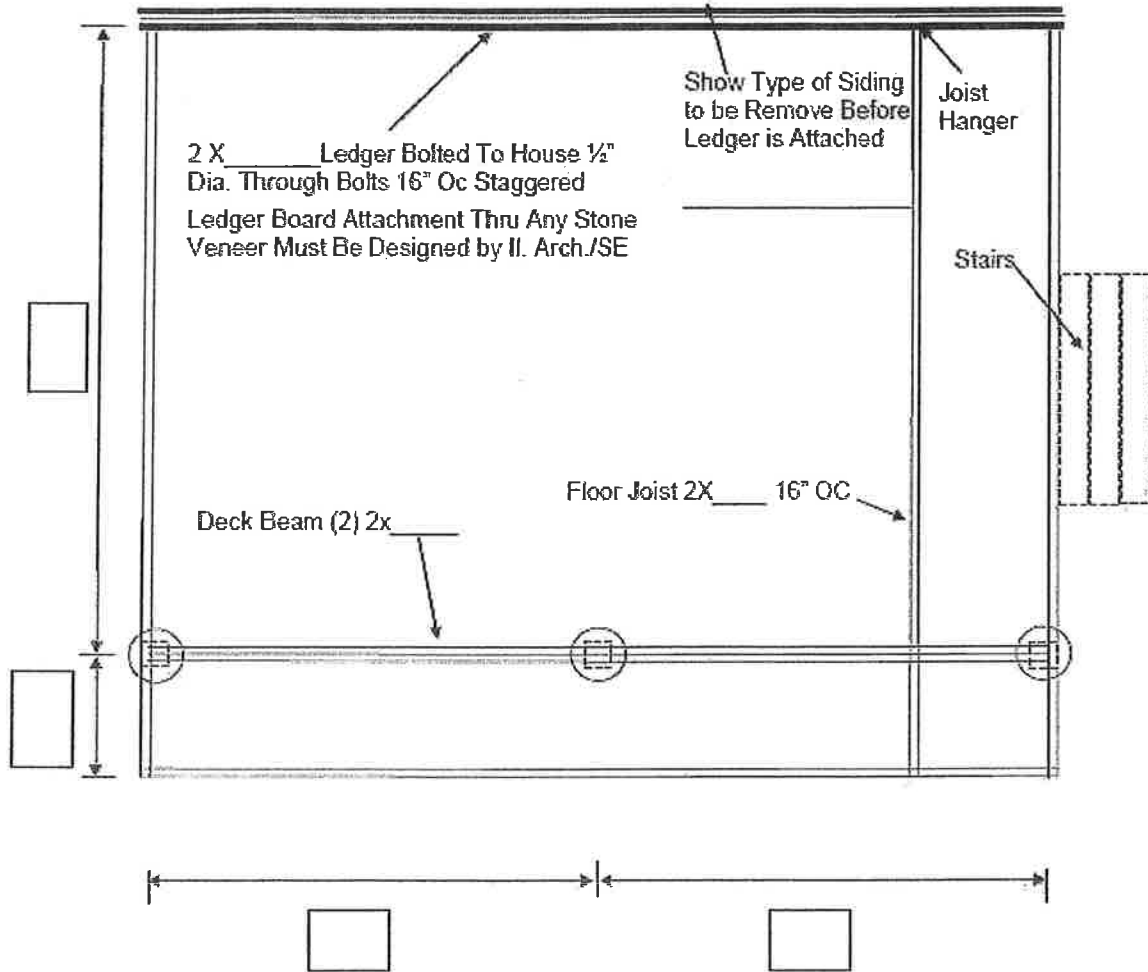

Show Additional Piers with Dimensions
Between Piers
Show Additional Beam Lines if Used with
Dimension Between Beams

Show Dimension Between
All Piers
Pier Size Minimum 12" Dia.
42" In Depth

Deck Framing Materials

Show Lumber Grade _____
Lumber Species – Southern Pine
or Mixed Southern Pine
(Circle One)

Lumber to be Pressure Treated –
Yes or No (Circle One)

Double Beam Deck Foundation Plan: Example Only

HOUSE

Remove siding before installing Ledger Boards. Provide Continuous Flashing With Drip Edge Over The Ledger Board

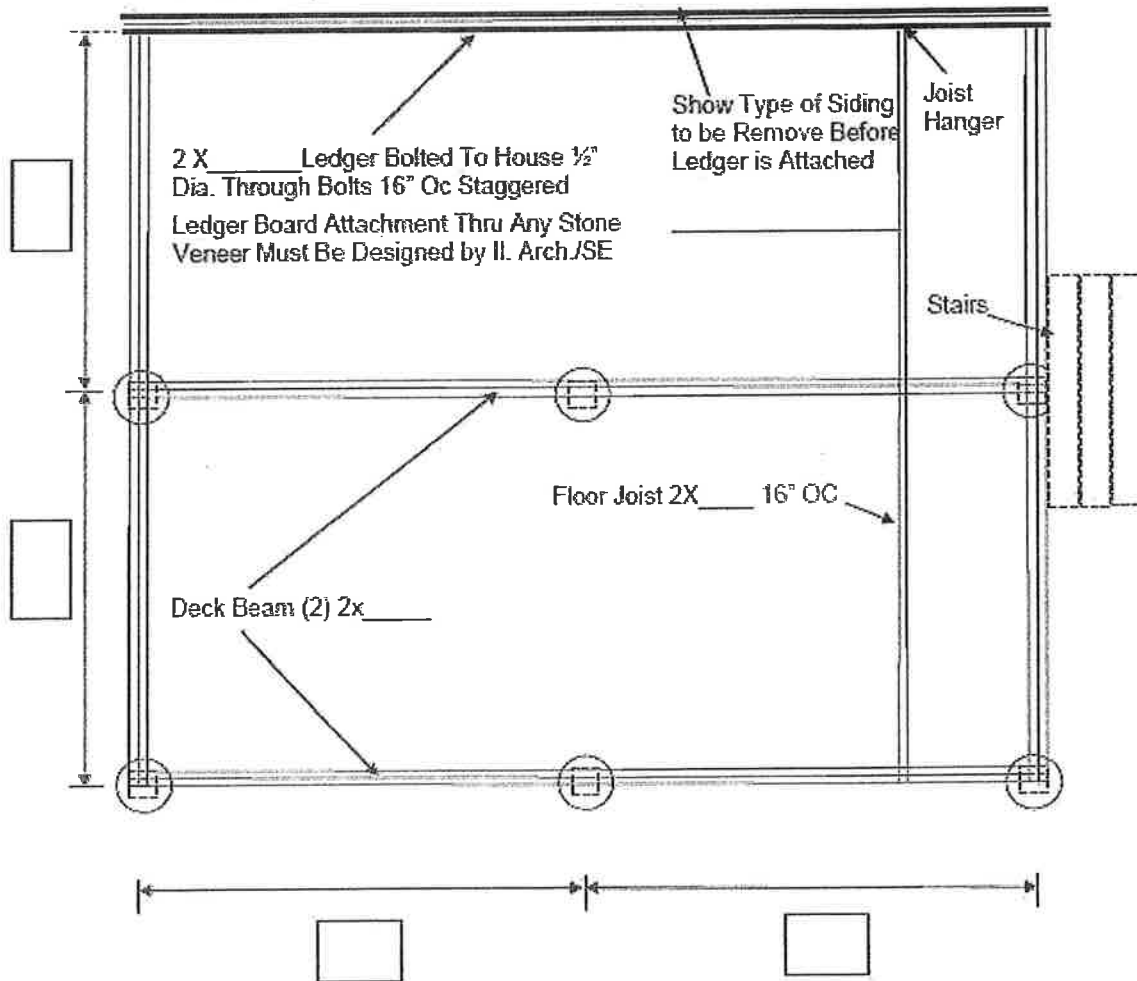

Show Additional Piers with Dimensions
Between Piers
Show Additional Beam Lines if Used with
Dimension Between Beams
Show Dimension Between
All Piers
Pier Size Minimum 12" Dia.
42" In Depth

Deck Framing Materials

Show Lumber Grade _____
Lumber Species – Southern Pine
or Mixed Southern Pine
(Circle One)

Lumber to be Pressure Treated –
Yes or No (Circle One)

Handrail required on stair with four or more risers.
 Handrail height 34"-36". Handrail grip-size R
 311.5.6.3 IRC code section.

DECK ELEVATION - SECTION SAMPLE INFORMATION

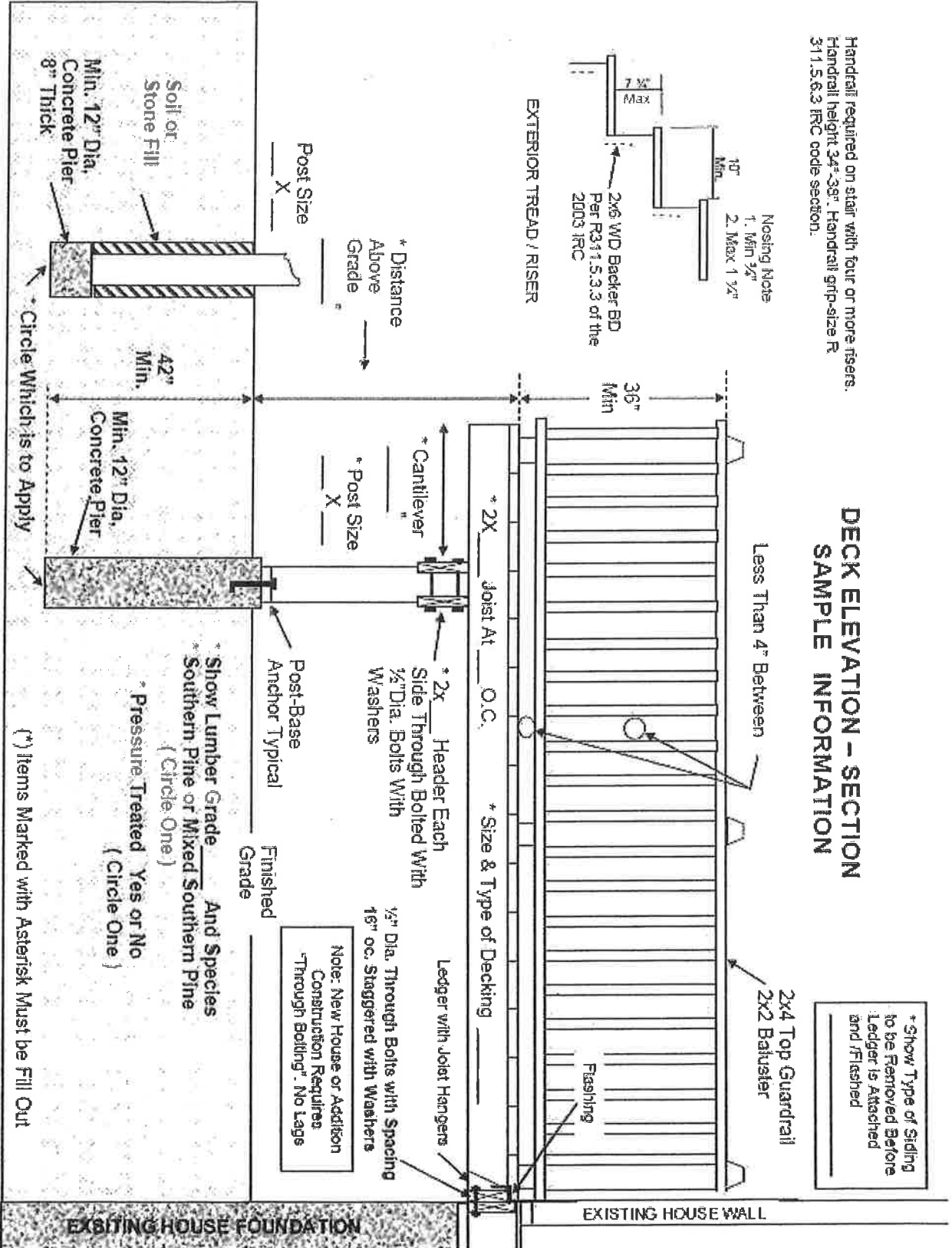
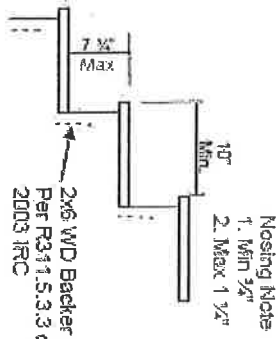

* Show Type of Siding to be Removed Before Ledger is Attached and / Finished

Note: New House or Addition Construction Requires "Through Bolting". No Lags

* Show Lumber Grade ___ And Species ___ Southern Pine or Mixed Southern Pine (Circle One.)
 * Pressure Treated Yes or No (Circle One.)

(* Items Marked with Asterisk Must be Filled Out)

